

# Becker\* Products

## FD-1500 Dryer

*Provides Filtration and Moisture Protection for all Becker Control Instrumentation*

The Becker FD-1500 dryer filters and dehydrates supply gas for all Becker control instrumentation. The FD-1500 dryer provides superior filtration and dehydration with 110 in<sup>2</sup> of 10 $\mu$  filtering media and 2.0 lbs. of silica gel. The FD-1500 dryer incorporates an easy-to-replace spin-on cartridge made of a high quality, high capacity nylon and fiberglass filter element reinforced with stainless steel mesh. All FD-1500 dryers are fully hydrotested to one and a half times the working pressure to help ensure pressure vessel integrity.

### Product Features

- Offers protection from excessive moisture, freezing and dirt
- Prevents clogging while providing 10 micron filtration, thanks to two-stage filter technology
- Hydrostatically tests to 2,250 psig
- Incorporates 2-inch pipe mount bracket
- Features a spin-on replacement cartridge for ease of change-out
- Offers internal access with an ordinary wrench thanks to machined (square) end of housing
- Absorbs up to 0.66 lbs. of moisture with high capacity silica gel
- Offers superior capacity filter element

**Table 1 - Specifications**

Specification	Value
<b>MAOP</b>	1500 psig
<b>Flow Capacity</b>	50 SCFM (1.4 m <sup>3</sup> /hr)
<b>Filtration</b>	10 $\mu$ nominal (110 in <sup>2</sup> filtration area)
<b>Dehydration</b>	2 lbs. (0.9 kg) silica gel moisture absorption
<b>Dimensions</b>	20-inch (508 mm) length 4-1/2" (114 mm) diameter
<b>Mounting</b>	2-inch pipe mount standard for all loose equipment
<b>Weight</b>	29 lbs (13 kg)



**Figure 1 - Becker FD-1500 Filter Dryer**

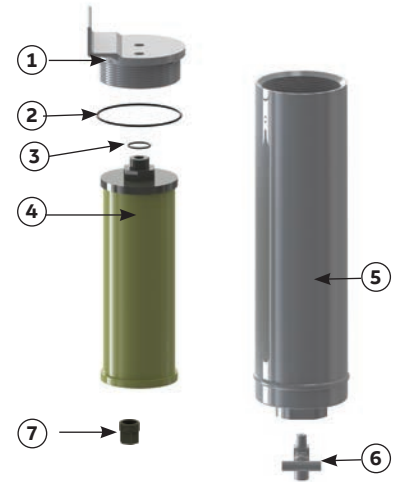

**Figure 2 - FD-1500 Filter-Dryer (exploded view)**  
Exploded view of the FD-1500 dryer illustrates the unit's simplicity.

**Table 2 - FD-1500 Filter Dryer Components**

Item	Description	Part Number
1	Upper filter housing flange	21-3012
2	Filter housing O-ring	95-2652
3	Filter cartridge O-ring	95-2653
4	Replacement cartridge (includes filter cartridge O-ring, filter housing O-ring, and compatibility adapter)	21-4003
5	Lower filter housing	21-3021
6	Drain needle valve	20-2926
7	Compatibility adapter	21-3090

**Table 3 - FD-1500 Dryer Materials**

Item	Description	Material
1	Upper filter housing flange	Carbon steel
2	Filter housing O-ring	Buna-N
3	Filter cartridge O-ring	Buna-N
4	Fine filtration assembly (second stage)	Nylon
5	Replacement filter cartridge tube	PVC
6	Drying desiccant	Silica gel
7	Coarse filter (first stage)	Fiberglass
8	Lower filter housing	Carbon steel
9	Drain needle valve	316 stainless steel

**Table 4 - FD-1500 Port Definitions**

Item	Description	Port Size
A	Inlet	1/4-inch FNPT
B	Outlet	1/4-inch FNPT
C	Drain	1/4-inch FNPT

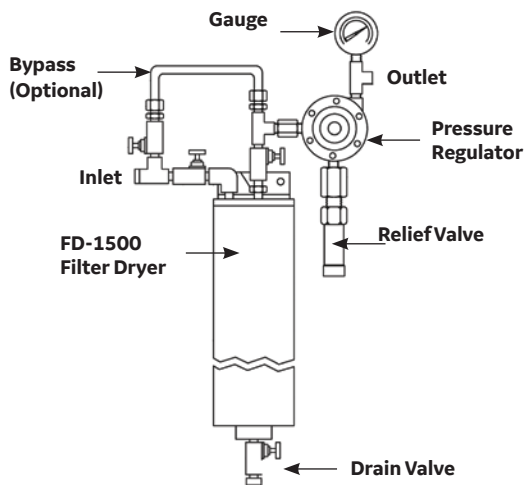

**Figure 3 -** Becker FD Series Gas Supply Systems Incorporate the FD-1500 Dryer. The economical FD-1 gas supply system provides complete regulation, filtration, dehydration, and relief in a single package.

**Table 4 - FD-1500 Port Definitions**

Item	Part Number
FD-1500 Filter Dryer (complete assembly)	21-3010
FD-1500 Filter Dryer replacement cartridge (includes filter cartridge O-ring, filter housing O-ring, and compatibility adapter)	21-4003

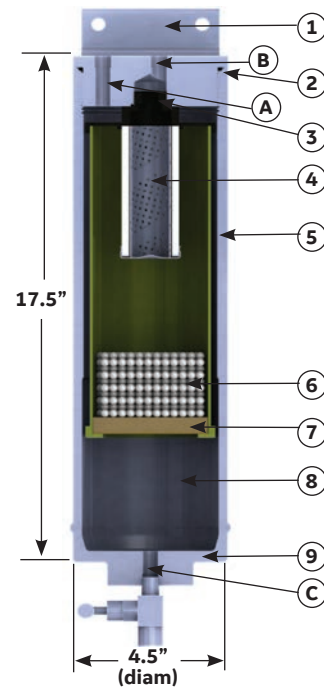

**Figure 4 -** FD-1500 Dryer (cutaway view) Cutaway view of the FD-1500 dryer illustrates main components and inner workings. The FD-1500 idryer is equipped with a high quality screen-reinforced nylon and fiberglass filtering media to prevent contaminants from damaging downstream instrumentation. Additionally, the FD-1500 dryer carries enough desiccant drying media to absorb up to 0.66 lbs. of entrained moisture. The FD-1500 dryer assembly contains a simple replacement cartridge that incorporates filtration and drying in one convenient module.

### Compatibility Adapter

Use the FD-1500 compatibility adapter to install FD-1500 replacement filter cartridges in other popular OEM filter/dryer housings. Take advantage of BHGE's two-stage filtration system and reduce your spare filter inventory without having to replace your existing filter housing. Simply thread the adapter onto a Becker FD-1500 replacement filter cartridge and it is ready to be installed in your existing filter housing. Contact your local sales representative for compatibility.



[bhge.com](http://bhge.com)

\*Denotes a trademark of Baker Hughes, a GE company, LLC. Other company names and product names used in this document are the registered trademarks or trademarks of their respective owners.

© 2017 Baker Hughes, a GE company - All rights reserved. Baker Hughes reserves the right to make changes in specifications and features shown herein, or discontinue the product described at any time without notice or obligation. Contact your BHGE representative for the most current information. The Baker Hughes logo is a trademark of Baker Hughes, a GE company. The GE Monogram is a trademark of General Electric Company.

